

PREPARED FOR:
COLDWELL BANKERS PRIMUS
c/o DEBBIE COBIAN
226 BROAD STREET
LAKE GENEVA WI
53147

PLAT OF SURVEY

- OF -

LOT 2 OF CERTIFIED SURVEY MAP NO. 781, LOCATED IN THE
EAST 1/2 OF SECTION 11, TOWN 1 NORTH, RANGE 17 EAST,
TOWN OF LINN, COUNTY OF WALWORTH AND STATE OF WISCONSIN.

J.K. SURVEYING INC.
N3705 WILLOWBEND LANE
LAKE GENEVA, WI, 53147
262-248-3697



- () = recorded as
- = found iron bar
- = found iron pipe
- = set iron pipe
- = set iron bar
- T = transformer
- ⊙ = telephone pedestal
- ⊕ = cable pedestal

SCALE 1" = 30'

JOB # 04-193

TAX ID # 1A78100002

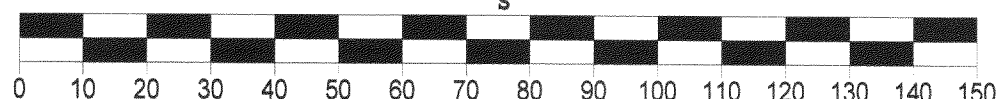

COMPARE LEGAL DESCRIPTION ABOVE AND DRAWING WITH DEED, FOR BUILDING RESTRICTIONS AND EASEMENTS NOT SHOWN, REFER TO DEED, ABSTRACT SOURCES AND LOCAL MUNICIPAL CODES. NOTIFY THE SURVEYOR IMMEDIATELY OF ANY DISCREPANCY.

"I hereby certify that I have surveyed the above described property and that the above map, to the best of my knowledge and belief, is a true representation thereof and shows the size and location of all visible structures, apparent easements and encroachments if any."

This survey is made for the present owners of the property, and those who purchase, mortgage, or guarantee the title thereto, within one year from the date hereof.

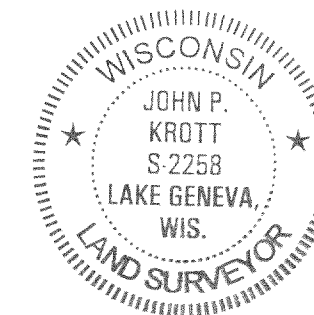
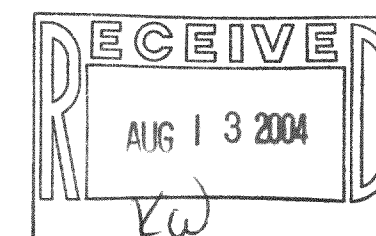

JOHN P. KROTT S - 2258
Wisconsin Registered Land Surveyor
(original if signed in red)
DATED THIS THE 4th DAY OF MAY 2004.

117-2441